

grosvenor
estate agents



18 Harvey Road, Croxley Green, WD3 3BW
Price Guide £750,000



Floor Plan

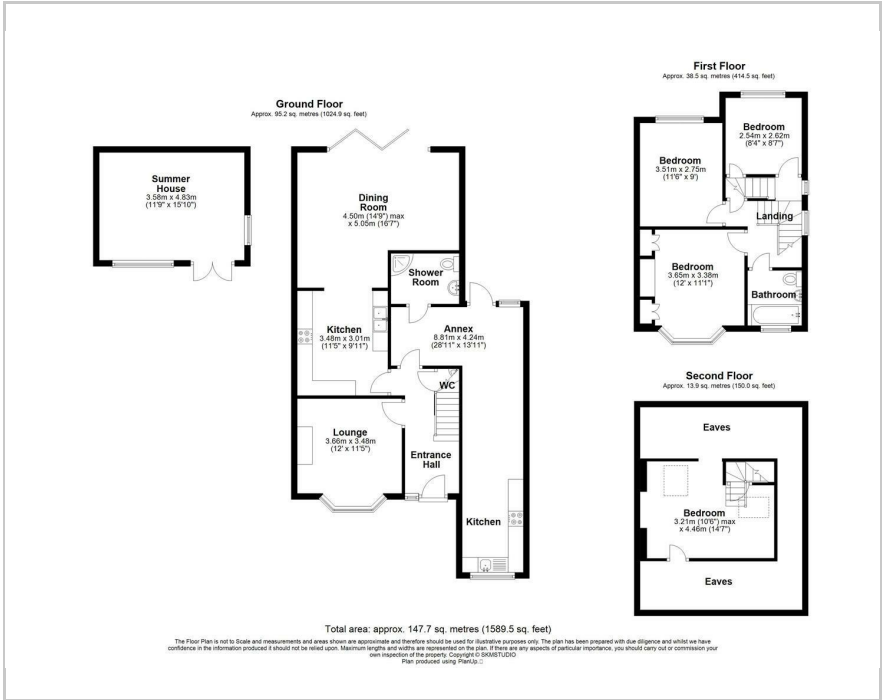

Area Map



Accommodation

- Close to Harvey Road and Rickmansworth schools
- Short walk to the Met Line station
- 4 bed semi detached with annexe to the side
- Annexe has kitchen and shower room with access from hallway
- Open plan kitchen/dining/family room
- Separate front reception room. W.C.
- Good size rear garden with a large summerhouse

Viewing

Please contact our Grosvenor Estate Agents Ltd Office on 01923 711651 if you wish to arrange a viewing appointment for this property or require further information.

Energy Efficiency Graph

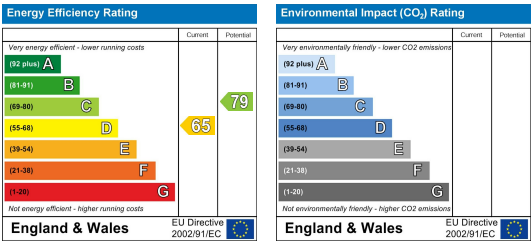

These particulars, whilst believed to be accurate are set out as a general outline only for guidance and do not constitute any part of an offer or contract. Intending purchasers should not rely on them as statements of representation of fact, but must satisfy themselves by inspection or otherwise as to their accuracy. No person in this firms employment has the authority to make or give any representation or warranty in respect of the property.